

**CARE AND MAINTENANCE**

Spot clean using a mild water-free solvent. Only a professional cleaner should undertake a complete overall cleaning.

The use of steam or water-based cleaners may cause excessive shrinking or staining.

**NOTICE**

\* Please make sure that you have all parts indicated before you begin assembly of this item

\* This item should be assembled on soft surface to prevent scratching the finish during assembly

\* This item may require periodic tightening



**Part List and Hardware List**

Model #SEA4004A

Product Dimensions :

PIECE	DESCRIPTION	PICTURE	QUANTITY
A	BACK		1X
B	SEAT		1X
C	FRONT LEGS		2X
D	CUSHION		1X
E	Nuts M8 x 60 mm & ring		8X
F	Pass Key		1X



Weight Capacity : 275 lbs  
WARNING : DO NOT STAND ON CHAIR

**PREPARATION**

Before beginning assembly of product, make sure all parts are present. Compare parts with package contents list and hardware contents list.

If any part is missing or damaged, do not attempt to assemble the product.

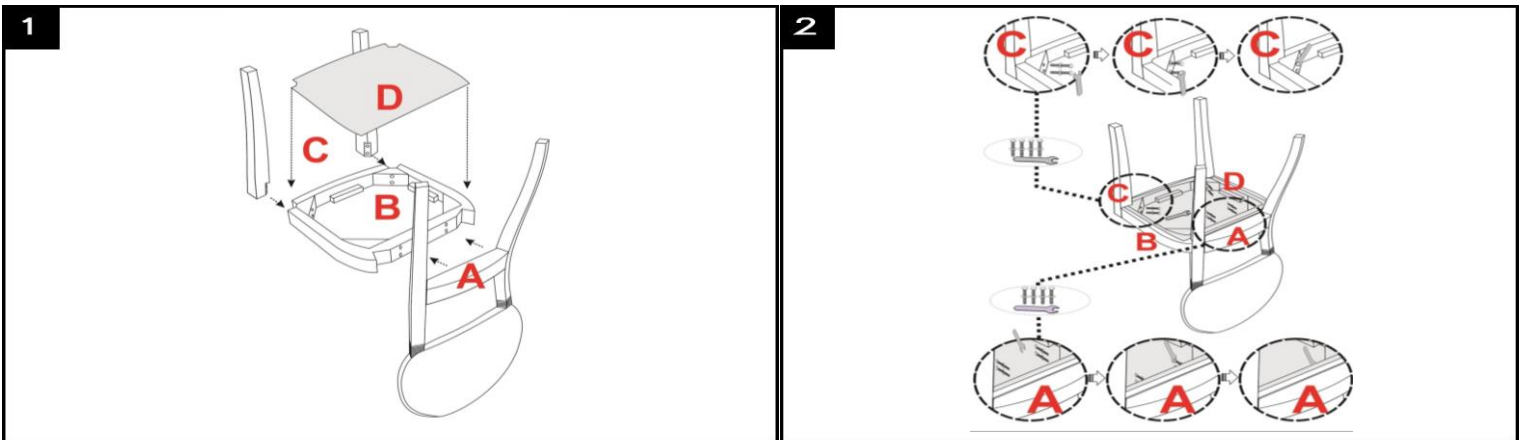

Assembly part A and B first with bolt Nuts M8x60 mm and ring  
 Assembly part C and B first with bolt Nuts M8x60 mm and ring  
 Assembly part D in upper Part B